

# County Stone

MASONRY UNITS



BROWN SUGAR

COUNTY MATERIALS CORPORATION

# County Stone

## MASONRY UNITS

Add character to your next project with County Stone Masonry Units. Our cutting-edge manufacturing process produces masonry units with a rough, hand-hewn appearance. Crafted using high-strength concrete, County Stone units are resistant to the elements and can last the lifetime of any building.



BROWN SUGAR

COUNTY MATERIALS CORPORATION



BROWN SUGAR

SUSSEX™ Blended Color Options

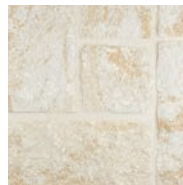

Sage  
(63-270C)

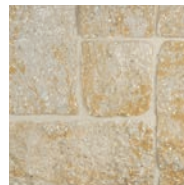

Locust Blend  
(63-267C)



Swiss Mocha  
(63-715B)

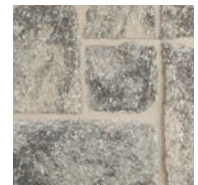

Smokey Mountain  
(63-271C)

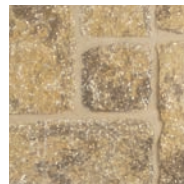

Cottage Brown  
(63-266C)

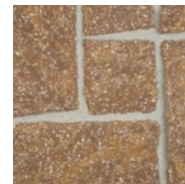

Brown Sugar  
(63-711A)

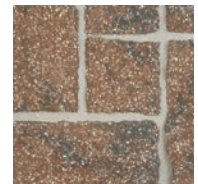

Cappuccino  
(63-712A)

**Letter following color names denote pricing levels.  
"A" indicates lowest price level; "C" is highest price level.**

*Colors, product data, and availability are subject to change without notice. Please confirm all details with a County Materials representative for availability in your area. Colors shown may vary from actual hues and should only be used as a guide. Refer to actual product samples for final color selection.*

Solid Color Options

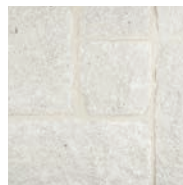

White  
(63-006C)



Cream  
(63-080C)

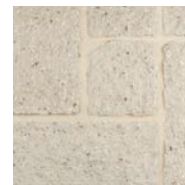

Summer Sun  
(63-713C)



Rocky Mountain Ash  
(63-264C)

# County Stone® Masonry Units

SHAPES AND SIZES



## COUNTY STONE® MASONRY UNITS

COUNTY STONE® masonry units are crafted of concrete and offer a natural textured veneer with the timeless appeal of hand-cut stone.

### COLOR AVAILABILITY

Units are available in solid colors and also in the Sussex™ blended color line, uniquely manufactured to produce blocks with integral color variations and marbling within each unit.

### FULL VENEER PRODUCT PACKAGING

County Stone may be utilized in multiple patterns. This product is packaged and shipped with two different Layer Patterns (see Layer Pattern drawings). The designated installation pattern on the job site must be field assembled from the individual pallets. Any blending of multiple colors and sizes must be done on the job site by the contractor/mason.

*Also, depending on the chosen pattern and the project size, additional splitting may be required on the job site by the contractor/ mason. Ask for information on calculating quantity of units needed per pattern.*

## FULL VENEER UNITS

**4" x 8" x 16"** Regular Solid

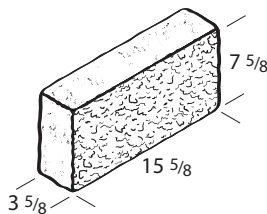

**4" x 8" x 8"** Two Qtr. Solid

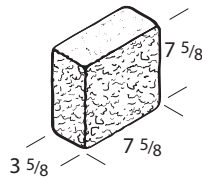

**4" x 4" x 16"** Half Course Solid

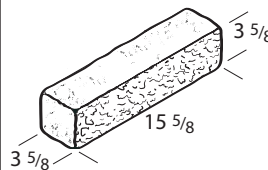

*All supplied with water repellent.  
Contact your local County Materials for product literature, samples and availability.  
All dimensions nominal.*



## FULL VENEER PALLET LAYERS

Sizes are mixed on one pallet

- 26.6 sq. ft. per layer
- 106 sq. ft. per pallet

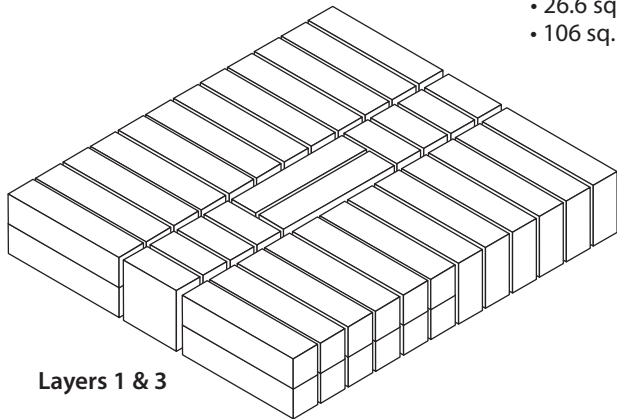

Layers 1 & 3

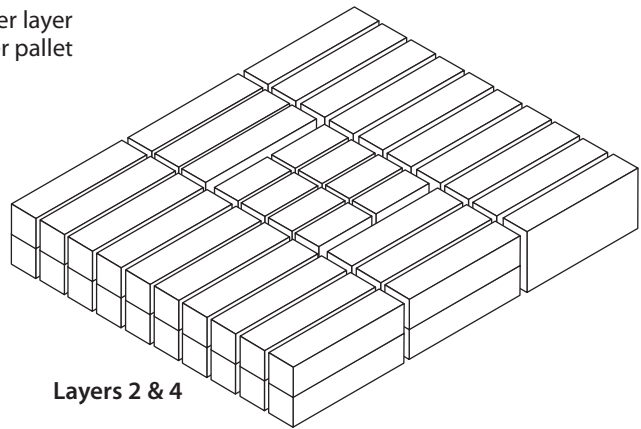

Layers 2 & 4

4) Full Sets of Pattern 2C (per layer)  
plus (1) 8 x 16 & (2) 4 x 16

Random Pattern 2C

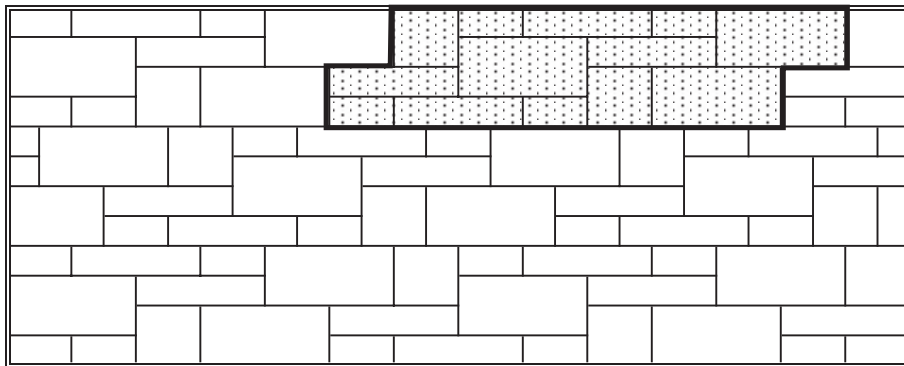

*All dimensions nominal.*



## COUNTY STONE THIN VENEER UNITS

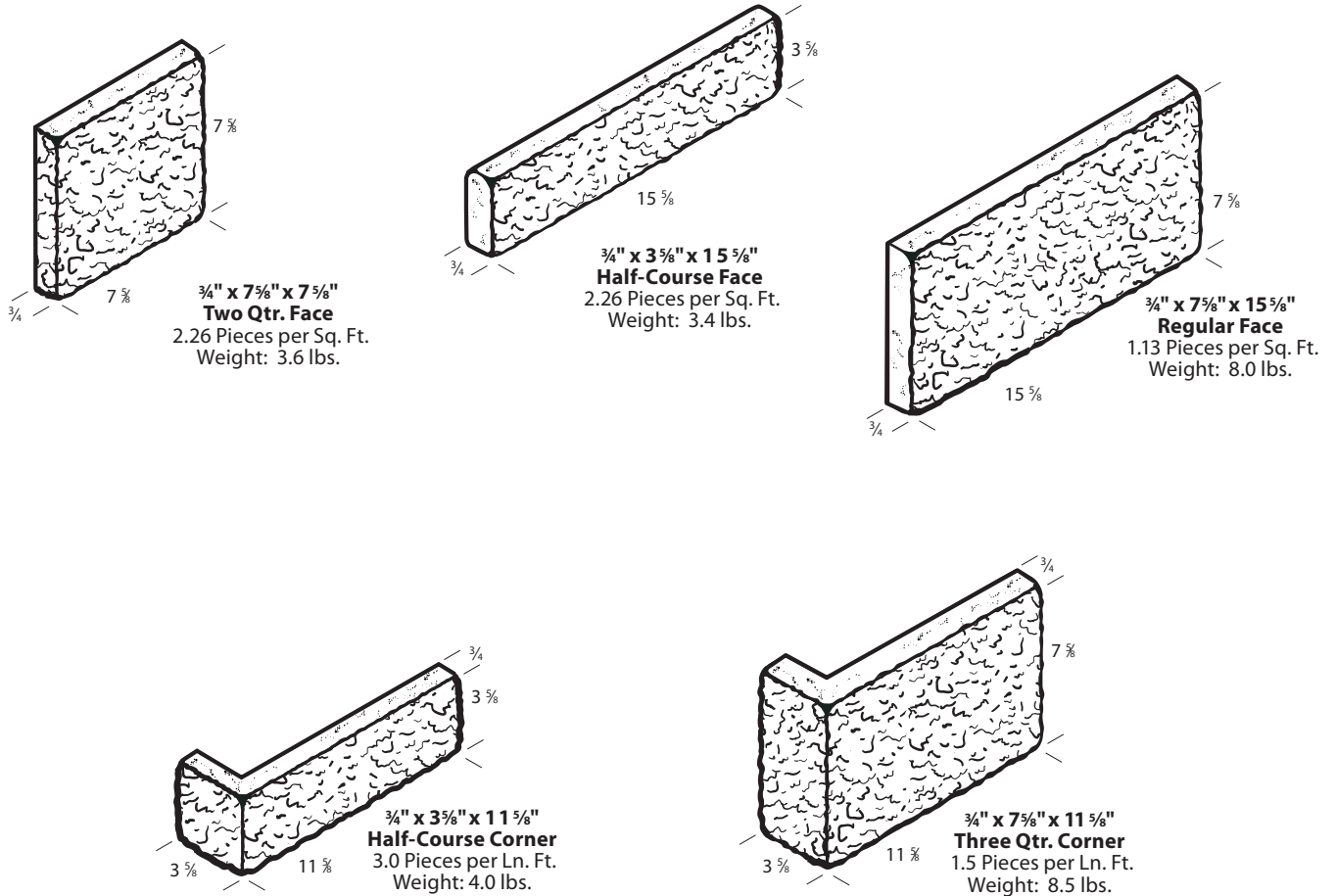

*All dimensions nominal.*

# County Stone

MASONRY UNITS

## Solid Advantages

- Ideal for interior and exterior applications
- Modular shape and diverse sizes enhance versatility
- Low maintenance

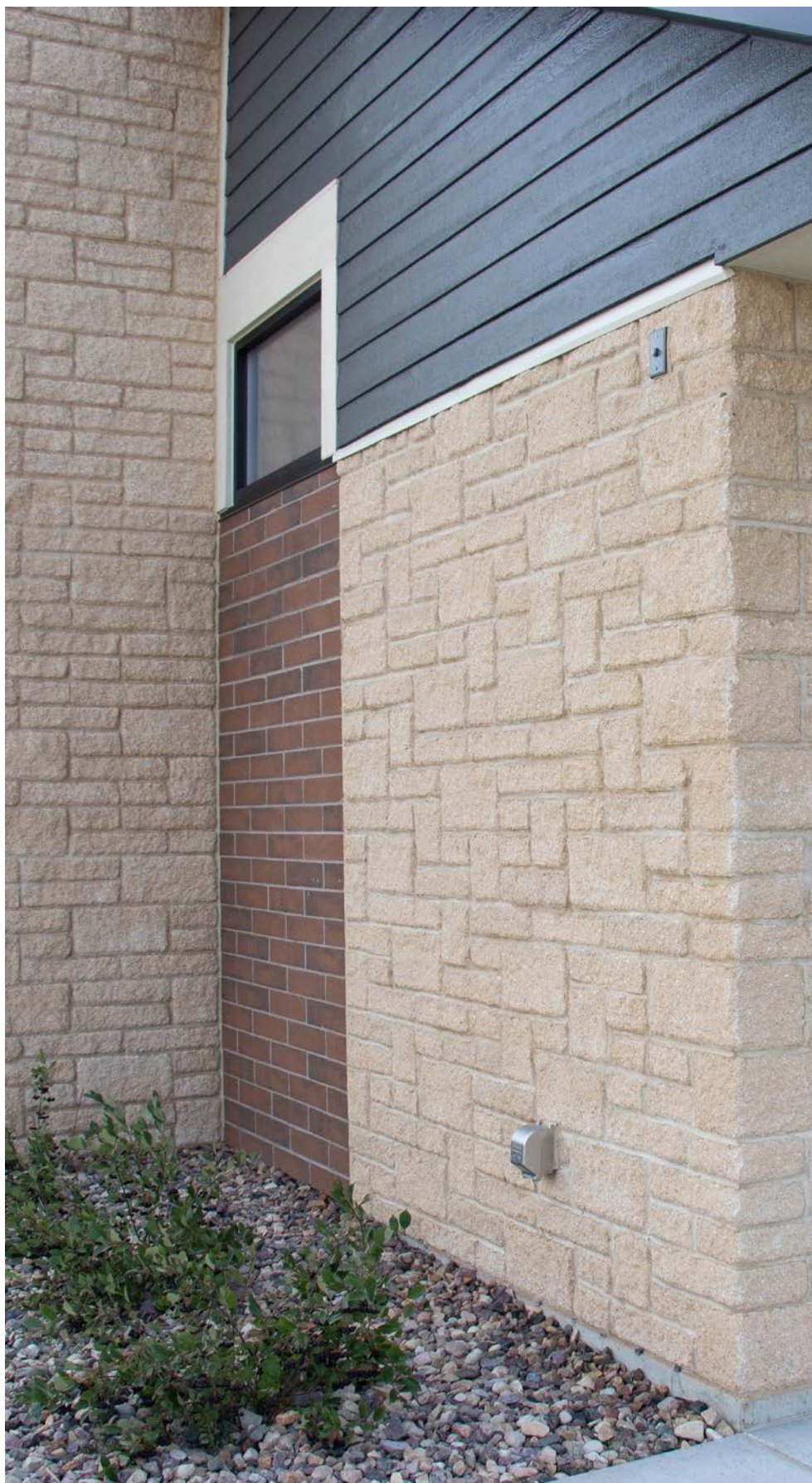

**(800) 242-7733**  
**countymaterials.com**  
info@countymaterials.com

©2022 County Materials Corporation • 836349663\_0522

COUNTY MATERIALS CORPORATION

CREAM